

# Thailand : Recent Finds at the Sanctuary of Kampaeng Yai

by M.C. Subhadradis Diskul

**A** new bronze image was discovered near the southern gate (gopura) of the galleries around Prasat Kampaeng Yai, (Sanctuary of Kampaeng Yai) on 17 May 1989.

Prasat Kampaeng Yai is located in Amphoe Utomporn Pisai, Sisaket Province in the northeastern part of Thailand. In front of the sanctuary are three towers or *prang* built in a row. There is also one in the back, at the southwestern corner. These four *prang* face the east. And facing the west, in the front, are two more structures known as libraries (see plan).

Since Kampaeng Yai is a Khmer sanctuary, one should expect to find another *prang* at the northwestern corner. This, however, cannot be found. And whether or not this *prang* crumbled down and was never constructed, is as yet unknown.

The lintel, on the northern library represents the reclining Vishnu. The one on the south represents Siva and his consort. Both of them are seen riding on the bull named Nandin. Anyhow, the lintel of the central sanctuary, which is still *in situ*, depicts Indra. Indra is the god of the eastern direction. He is seen riding upon his elephant mount, Airavata, among foliage scrolls.

Interestingly, all the *prang* are built in bricks but the pediments, lintels and door-columns as well as



**Fig. 1** The 140 cm. high bronze statue found at Prasat Kampaeng Yai in the province of Sisaket, northeast of Thailand.

the surrounding galleries are carved from sandstone. From the stone carving Prasat Kampaeng Yai can be dated back to the end of the 10th and the early 11th centuries A.D. (Khmer Khleang - Baphuon styles).

On a door-jamb of the eastern gate at the galleries, there also exists a Khmer inscription. And as Professor George Coedes has deciphered, its date is equivalent to 1042 A.D. This Khmer inscription is composed of about 35 lines in Khmer language. It relates the buying of lands in 1042 A.D., by Vrah Kammraten An Sivadasa with the help of three other dignitaries. The lands mentioned were marked, as described on the inscription, and were dedicated to the God Vrddhesvara. (G. Coedes : Inscriptions du Cambodge, Vol. VI (1954) p. 251)

Of all the findings at Kampaeng Yai Sanctuary the standing bronze statue, discovered near the southern gate of the gallery, is most outstanding. The statue, standing 184 cm. high (140 cm. for the body, 10 cm. for the base and 34 cm. for the tenon underneath), was discovered near the southern gate of the gallery. Surprisingly, the statue was only 10 cm. under the ground, the original level of the sanctuary.

No doubt, the statue represents a standing *dvarapala* (door-guardian). Its left hand rests on the left hip. But the upper part of this arm has been



**Fig. 2** The missing “butterfly knot” on the back of the statue’s belt characterizes the Khmer Baphuon style.

is typical of the Khmer Baphuon style as it curves down deeply on the abdomen, and rises rather high on the back. The “butterfly knot” on the back of the belt characterizes the Khmer Baphuon style. It was probably cast apart and then joined to the body but has later disappeared (Fig. 2).

The face again typically denotes the Khmer Baphuon style. The style is especially obvious in the technique of inserting more precious metals, such as gold or silver, as inlay for the eyebrows, the eyes, moustache and the beard (Fig. 4).

Professor Jean Boisselier, a French expert on Khmer art, has written an article on this statue. His article is divided into three sections: technique of the execution, icono-

graphy and problems of conservation, and the presentation of the statue.

In his article Professor Boisselier writes that the statue was casted, with earth and an iron axis inside. According to him, it is the only known example of a large sized Khmer bronze statue formed with this technique of casting. Therefore, one should x-ray the statue in order to find out the nature of the interior parts.

The standing bronze image of Bodhisattva, found at Ban Fai in the province of Buriram, Northeastern Thailand, should also be x-rayed to find out whether it was casted in the ancient tradition of Northeastern Thailand or in an innovation of the Khmer Baphuon style.

The professor reminds that the large reclining Vishnu image, discovered at Prasat Western Mebon in Cambodia, was casted in the *cire perdue* method. It is hollow inside. The bronze images of the Bodhisattva, found at Prakhon Chai in the

broken and the lower half of the right arm has disappeared.

The statue is standing straight but, curiously, the front part of its right foot protrudes out of the pedestal (Fig. 1). This statue must have, originally, worn a diadem. Anyhow, on the back part of the head one can still see vertical lines of braided hair, bordered by a small beaded rim.

The statue is wearing a necklace, two armlets, a belt and two anklets. The necklace has no pendants on the front but is decorated with nine of them on the back. The necklace and the two armlets are ornamented with large floral motifs at the middle but the anklets are simple.

The belt is decorated with oval designs, hanging floral pendants underneath, and a buckle. The dress

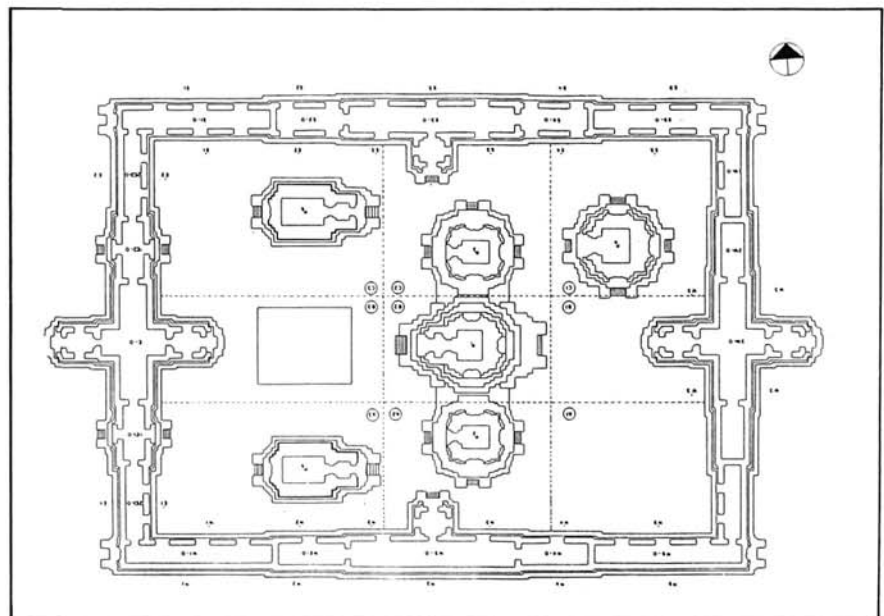

**Plan of the Sanctuary of Kampaeng Yai**

same province of Buriram, used the same method of casting. It also has a small iron axis inside.

From these small sized statues, 45 to 50 cm., it seems this method of casting was already used in North-eastern Thailand between the eighth to the ninth centuries A.D.

Then Professor Boisselier explains further on the statue at Kampaeng Yai Sanctuary. Because of the attitude and gesture of the statue, he says it could be identified as a dvarapala.

The form of the statue's hair might be a *jatamukuta* (crown of hair) or a *Kintamukuta* (a cylindrical hat), decorated with semi-precious gems. As for the attribute on the right hand, noticeably, there is no trace of it on the pedestal. The front part of the arm might have been hanging down. But this gesture, although it exists in the Indian Chola style, has not been found in the Khmer art.

The front part of the statue's right arm might be folded and may be jutting out at the same level with the waist. If so, this latter gesture is for a dvarapala. A dvarapala holds a club. But as has been said there is no trace of a club on the pedestal, neither on top nor on the lateral side.

There is one *Durga Mahisasuramardini* (Uma killing a buffalo-demon) in bronze, dated about the middle of the tenth century. In this statue, the club rests on a lotus, the stem of which is attached to the lateral side of the base. From here there are now two possibilities :

1. The statue at Kampaeng Yai Sanctuary might be holding a small club vertically. There are many bronze examples of Khmer divinities holding a club vertically. These statues date back to about the 12th century A.D.



**Fig. 3** Because of its attitude and gesture, this statue could be identified as a dvarapala (door-guardian).

But they are quite small images.

2. The attribute of the Kampaeng Yai statue is not a club. It is something like a spear, even better, it is a trident (*trisula*). As is well known, a trident has a very short handle. From the end of the eighth century A.D. when statues such as the Hari-

hara of Prasat Trapeang Phong in Cambodia were represented as holding a trident, up to this time tridents only seem to belong to divinities, and not to door-guardians.

However, Professor Boisselier thinks this bronze statue discovered at Prasat Kampaeng Yai represents Nandikesvara or Nandisvara, chief of the



**Fig. 4** The statue's face clearly indicates that it was inlaid with another type of metal. The technique of using more precious metals, such as gold or silver, as inlay for eyebrows, eyes, moustache and beard was typically used in the Khmer Baphuon style.



**Fig. 5** The cracks on the statue may have resulted from the internal pressure of the earth, caused by the corrosion of the iron axis inside.

*gana* (attendants of Siva). Because of his loyal services, Siva allowed Nandikesvara to change his primitive appearance, which resembles a monkey, to the likeness of Siva.

The way the statue is depicted, that is, it has no third eye on the forehead, is not surprising. Because in Khmer iconography, all images of Siva are not provided with the frontal third eye (*trinetra*).

And even if the statue is not really Nandikesvara, Professor Boisselier still thinks this bronze statue is a door-guardian. The way it was gilded and its excellent execution are invitations to suppose that this statue must have stood in front of the central sanctuary of Prasat Kampaeng Yai, or even inside its porch.

This bronze statue could have even stood in front of the southwestern sanctuary of Prasat Kampaeng Yai. This structure was probably the most important and sacred place. This place has a pedestal for two images, probably for Siva and Uma. If so, the structure then represents the Kailasa Mountain, their abode. And therefore it should be guarded by Nandikesvara and his mate.

The *dvarapala* normally stand as a couple. The discovered statue then should have a mate on the other side of a door or at a guarded passage.

At the central sanctuary of Prasat Banteay Srei in Cambodia (967 A.D.) there are sculptured statues in front of its porch and false-doors. One of these figures might represent the mate of the Kampaeng Yai bronze statue and may have the same appearance as the Kampaeng Yai statue.

Probably, the mate for the Kampaeng Yai statue more or less

looks fierce and may have some negroid traits. It has much hair and a rather corpulent body. These are the characteristics of Mahakala, a habitual mate of Nandikesvara. These pair of guards are represented, as figures in high-relief, at Prasat Prah Ko, also in Cambodia (879 A.D.). One should also remember that the Nandikesvara-Mahakala are always associated with the sanctuaries of Siva.

The presence of these two guardians, in Khmer art, are so common, sometimes they are no longer mentioned in Khmer iconography for Siva temples. On the contrary, however, they appear in the epigraphy of a Vishnuite sanctuary.

Because of all the foregoing, in addition to the mutilations of the statue, Professor Boisselier thinks there should be a search for the statue of Mahakala. Even if there is very little chance of discovering it, a metal detector could be used in the inner courtyard as well as in the area from the porch of the central sanctuary to the corresponding gate and in front of the southwestern sanctuary until the southern gate. One might find some fragments of the two bronze statues which might have been left or forgotten during a very ancient theft.

Considering the problem of conservation and presentation of the statue, Professor Boisselier thinks there are many problems. Because the long and important vertical cracks on the statue and its base (see Fig. 1) might have occurred from the composition of the bronze, which should be determined.

However, the professor does not think the principal cause of the cracks lie in the nature of the metal alloy. He thinks the composition of the earth inside and the iron axis might have



caused the danger. Although the earth inside the statue is not supposed to be in contact with any material outside, when the bronze statue was mutilated, it fell onto the ground and received water from every rainy season.

Because water permeated in the earth inside the statue, corrosion of the iron axis followed, causing internal pressure. As a result, the metal gave way and cracks are now visible, both on the length and the width of the statue. The corrosion on the external bronze should be extinguished as soon as possible.

The first thing to do is to observe whether the cracks on the bronze are stable or augmented. But the method to stop the cracks, especially the corrosion, is yet to be found. The present cracks cannot be filled and this should not be executed as it might destroy the aesthetics of the statue and might add to its volume. One should find out the way to stop the causes of these cracks.

Professor Boisselier thinks this method might now be existing. The method used for the restoration of the bronze horses at St. Marc's Cathedral in Venice, Italy, might, in fact, be the answer.

To discover the metal alloy of the statue a small part of the bronze at the back of the right shoulder of this dvarapala could be cut. This should be done before restoration and the selection of the laboratory that will be utilized for treating the statue.

As for the presentation of the statue, a strong inconspicuous metal should be used to support the figure under its shoulders, so that the level at the ankles will not be broken. An x-ray of the statue could reveal more information about the figure.

**Right: Fig. 6** The statue's necklace is simple at the front but elaborately decorated with nine pendants at the back.

**Below: Fig. 8** The armlets on both arms are ornamented with large floral motifs at the middle but the anklets are simple.



Professor Boisselier recommends the use of a closed glass case in the display of the statue. This, he says, will protect the bronze statue from penetrating moisture. The statue should be the only display inside the glass case.

The base and the tenon underneath should also be shown in the display. Well protected, the statue of Kampaeng Yai should be permanently exhibited in the Bangkok National Museum.

At the end of his article, Professor Boisselier, compares the bronze statue of Kampaeng Yai to the torso of Vishnu from the Sanctuary of Western Mebon (now in the National



**Fig. 7** Because of its excellent workmanship, one is tempted to think this statue must have stood at the most important and sacred tower of Prasat Kampaeng Yai.

Museum of Phnom Penh, Cambodia) and the two Bayon Style bronze dvarapala, more or less broken and kept at the Arakan Temple, Mandalay, Burma. He says that though they are larger than our bronze statue from Prasat Kampaeng Yai, they do not present comparable problems for conservation.

Professor Boisselier kindly sent, to the author, a number of pictures of statues resembling the bronze dvarapala at Prasat Kampaeng Yai. And from these pictures, the author opines that the statue that looks closest to it in appearance is the one that is supposed to represent Siva at the Melbourne Museum, Australia!

■

**N**ias is the largest among the islands in the west side of Sumatera, Indonesia. It is an isolated island and has a unique and attractive culture, which has survived millions of years.

The culture of Nias is very distinguished in terms of its megalithic tradition. Local people still build and use megalithic structures in their present ceremonies. In fact, this ethnoarchaeological data can be utilized as a comparative reference in the reconstruction of the social, economic and religious backgrounds of the Nias people.

Several scholars have previously studied the culture of Nias. For example, in his book entitled "Das Kopfschnellen auf Nias", A. Fehr described the head hunting ceremony of Nias for the death of a chieftain, during the feast of merit and the establishment of an assembly house. R. Horsky, in "Religiose Holzplastik auf Nias", described in detail the wooden statues of Nias and their religious meaning, especially the specimens collected in the "Museum fur Volkerkunde" in Vienna.

But in 1981 a systematic study was carried out by a team, led by the author, from the National Research Centre of Archaeology (NRCA). The study focussed on a number of megalithic sites, both in Central and South Nias.

Megalithic objects in Nias are regarded as important mediums for ancestral worship. The megalithic societies of Nias generally established and erected megaliths on high hills or terrains.

In the article "The Arts of Nias" von Heine Geldren explained and discussed the arts of Nias and presented a series of very fine pictures. Here he concluded that the megalithic culture of Nias is a mixture of elements belonging to the older

## The Megaliths of Nias Island

by Haris Sukendar



A menhir statue from Onowembo Telemaera.

# MAP OF NIAS ISLAND



0 15 km

and the younger megalithic traditions (Heine Geldren and Loeb, 1935).

The younger megalithic tradition is revealed in megalithic statues and menhir statues representing human beings or the king of faunal beings, locally known as *sitilubagi* and *neobehe*. Menhirs, in this tradition, have different decorative patterns. *Neoadulomano* and *neogadi*, two kinds of stone tables, are each supposed to represent a female lying on the ground beside the standing menhirs.

The older megalithic tradition, on the contrary, show huge and simple menhirs. Here stone terraces are used as graves or places for offerings.

Anyhow, the purpose of megalithic statues representing the human figure is very significant in Onowembo Telemaera, Ononamolo and Onositoli.

## THE MEGALITHS OF CENTRAL AND SOUTH NIAS

### *Onowembo Telemaera*

The menhir statue found in Onowembo Telemaera is made of greyish limestone. It is 155 cm. high and 40 cm wide, with elaborate eyes. The nose and mouth are simply outlined but the lips are large and curling. It has a broad and protruding tongue as well as a male genital. The statue carries a creese (dagger).

According to the local people, the menhir statue represents the chieftain. This very important information, by the way, contributes to data found on the functions of menhir statues. The statue is still worshipped by the local people, especially in curing illness.

The menhir statue of Onowembo Telemaera still stands *in situ*, near the house of the chieftain. It is in association with other stone structures,



Human head statues from Onozitoli.

menhirs and altars, locally known as *dane-dane*. All of these megalithic objects, arranged in a courtyard, are usually located in the centre of the village. The courtyard is used for setting offerings.

The courtyard at Onowembo Telemaera is rectangular with two parallel lines of menhirs and altars. This arrangement is still intact, particularly the menhir statue standing on the southern part of the courtyard.

A stone structure, on an oblong ground plan (length: 255 cm., width: 85 cm.), is found about a hundred metres to the southeast of the menhir statue. It is built from unprocessed stones. According to the local people, it is the tombstone of the first chieftain who settled in this village, hundreds of years ago. This tombstone is not worshipped any longer. Hence, it is now covered by dense shrubs and vines.

At the west end of the courtyard is a terraced stone grave. It is 3.5 metres long, 15 metres wide and 60 centimetres high. It is believed to be

the burial site of a former chieftain.

### *Onozitoli*

The megalithic site of Onozitoli is located on a hill. To reach the site, one has to walk along stepped slopes, cross five rivers and pass through deep gorges. The site lies on a stepped plateau. At present, about 30 families live in round piled houses.

In the site, megalithic statues, including two human head statues, still stand in front of the house of the chieftain. According to the villagers, these megalithic statues represent previous chieftains. They are regarded as ancestral statues and are still worshipped today. The height of the statues vary from 75 to 85 centimetres.

The courtyard, where the megalithic elements stand, is used for carrying out ceremonies and festivals, including the slaughtering of pigs.

During any house construction or funeral gathering, villagers usually dance together in this courtyard. They bury their dead near the village and then cover it with a square stone structure.



The human head statues located in front of the chieftain's house represent sacrificed victims, before the erection of a huge menhir. Heads of human foes are regarded to have magical powers. Prehistoric people believed that parts of the human head such as the hair, head, and nails had magical power. The human genital organs were also believed to have this power. Nowadays, however, villagers use statues of buffalo heads instead of human heads in ceremonies, particularly in the construction of huge monuments.

The existence of megalithic statues, representing the human figure, and human head statues prove that the megaliths from Onozitoli belong to the younger megalithic tradition. They may have developed after the megalithic tradition of Gomo, indicated by the huge and crude menhirs. The legend of Onozitoli mentions that the earliest settlement of Nias is Gomo, which is now a district situated in the hilly area of South Nias.

Also found in Onozitoli are the altars, known as *dane-dane*. A *dane-dane* is a female symbol said to be used as the stone seat of the deceased. Intended as a memorial for the dead, it is also regarded as the resting place for the deceased's soul.

A *dane-dane* is usually found on the ground. On its side is usually a menhir. In Nias, a menhir is considered as a male symbol and as a phallic representation.

### **Tundrumbaho**

Tundrumbaho is located on a hilly and cloudy plateau, about 520 meters above sea level. The site is 120 meters long and 50 metres wide.

In front of the site is a stone terrace known as *areosali*. It is used as a sitting place during council

meetings or any festival. Standing beside the terrace is a large *neogadi*. The chieftain usually sits on the *neogadi* when he decides on a penalty.

Megalithic remains are arranged in a row on the right side of the site. On the left side, is a long terrace where traditional houses were once located. A number of menhirs stand in the centre of the courtyard. They consist of sword shaped menhirs,



menhirs with human face decorations, menhirs with geometric decorations, simple menhirs, etc. This group of menhirs are usually called *saitagiri*.

Menhirs called *saitagiri* are used to mark places for weapons belonging to the chieftain in any ceremony or council meeting. *Neogadi* and *neoadulomano* belonging to the chieftain's wife are arranged in a row and are used to mark places for dancers during ceremonies.

Two types of *neoadulomano* are found in Tundrumbaho: the undecorated and the decorated. Decorations of *neoadulomano* are usually *tumpal* or triangles, double spirals, "S" shapes, *vahasaradede* or circles, etc. A *tumpal* decoration is also known as *neofulayo*, meaning power. *Vahasaradede*, on the other hand, are circles representing unity.

**Left: A menhir, or an upright stone, from Tundrumbaho.**

**Below: Harvena, or stone tables with the geometrical design, also from Tundrumbaho.**



On the wall of the areosali are carved decorations in bas relief representing a human dancer and a crocodile. In prehistoric mythology a crocodile symbolizes the audacity of the chieftain.

A similar design is also found on a *penji*, a kind of menhir from Sumba island. On the lid of a large *sitilubagi* is a decoration depicting mother's breasts. This decoration is also found at the entrance of the traditional house of the chieftain of Kewar, West Timor. A megalithic statue with large mother's breasts was found by Hasan Muarif Ambany in the Regency of Sukabumi. This design is supposed to symbolize fertility.

A very interesting find at Tundrumbaho is the square hole carved on top of a large menhir. This square hole was used to preserve the corpse of the former chieftain. This data about the function of menhirs has never been found in other sites in Indonesia. But other menhirs were used in skeleton preservation.

### *Sifarauasi, Gomo*

Sifarauasi is located on a high hill, about 320 metres above sea level. The megalithic site of Sifarauasi can only be reached by climbing slippery tracks and crossing shrubs. Artefacts are concentrated in a very limited area of 50 metres long and 10 metres wide.

In this site the presence of *neobehe* is very dominant. Contrary to the *neobehe*'s general height of about 65-100 centimetres, the *neobehe* from this site are very small. They vary from 20 to 50 centimetres high. It is very difficult to explain this size discrepancy.

The largest *sitilubagi* stands on the west end of the yard, in association with other megalithic elements.

About 20 *neogadi* and *neoadulomano* are in this place. There are also one decorated and three undecorated *sitilubagi*, all of them oriented to the east. The largest *sitilubagi* is slightly shaped but is very richly decorated.

Some *sitilubagi* and *neobehe* are broken and have gone into ruins. On the northern side of the yard are *sitilubagi*, *neobehe*, *neoadulomano* and *neogadi*, collected under the thatch grass and shrubs. On the lid of a *sitilubagi* is a fine lizard decoration. It is carved in parallel lines in association with geometrical decorations, such as S-shape, triangles (*tumpals*), doubled spirals and circles (*vahasaradede*).

Six metres outside the west end of the yard are two menhir lying on the ground. This place could be the entrance to the yard. *Sifarau* means "can see", while *as* means "the sea". *Sifarauasi* therefore means "can see the sea". From *Sifarauasi* one sees a magnificent view of the countryside, particularly when the sky is clear.

## CONCLUSION

The megalithic objects from Nias are specifically designed, not found outside of Nias. They are exceptional and significant. The people of Nias are many isolated ethnic groups, still practising megalithic worship.

The megalithic culture or tradition of Nias Island survives until the present. It is a living megalithic tradition. ■

## Glossary

### Neoadulomano

A kind of stone table used for ceremonial purposes.

### Neobehe

An animal statue used for ceremonies.

### Sitilubagi

Another animal statue used for ceremonies.

## REFERENCES

- Heekeren, H.R. van. *The Bronze-Iron Age of Indonesia, Verhandelingen van het Koninklijk Instituut voor Taal-Land en Volkenkunde*, XXII, The Hague, Martinus Nijhoff, 1958.
- Heine Geldern, R. von. *Prehistoric research in the Netherland Indies, Science and Scientist in the Netherland Indies*, New York: Board for the Netherland Indies, Surinam and Curacau., 1945. pp 129-167.
- Heine Geldern, R. von and Loeb, E.M. *The Archaeology and Art of Sumatra*. 1935.
- Hoop, A.N.J. Th.a. Th van dar. *Megalithic Remains in South Sumatra*. Trans. by W. Shirlaw. Zutphen: W.J. Thieme, 1932.
- .....*Steenkistgraven in Goenoeng Kidoel* KITLV, 1935, Vol 75, pp 83-100
- .....*Indonesia Ornamental Design*. Published by the Koninklijk Bataviaasch Genootschap van Kunsten en Wetenschappen., 1949.
- Kaudern, Walter. *Ethnographical Studies in Celebes V. Megalithic Finds in Central Celebes*. Goteborg. 1938.
- Kleiweb de Zwaan, J.P. *Het eiland Nias en zijn bewoners Nederlandsch Indie Oud en Nieuw (NION)*, 1927, XI, p 323-341 and 355-372.
- Loofs, H.H.E. *Elements of the Megalithic Complex in Southeast Asia*. An annotated bibliography, Canberra: Australian National Univ. Press, 1976.
- Perry, W.J. *The Megalithic Culture of Indonesia*. Manscester, 1918.
- Soejono, R.P. *Sistim-sistim penguburan pada akhir masa prasejarah di Bali (Late prehistoric burial systems in Bali)*. 1977.
- Sukendar, Haris. *Laporan penelitian kepurbakalaan di pulau Nias*. Report on an archaeological research in Nias Island. 1983.